

VINTAGE BRITISH PASSPORT

This prop is an authentic replica of a British Passport of the 1920s.

To Assemble Cover:

Print cover wrapper on white or off-white paper. **Cut off** white margins. Use a straight pin or thumbtack to **poke** small holes in the paper where the small gold dots appear.

Print cover boards on cardstock or bristol board. **Cut out** rectangles.

Glue cardboard rectangles to back of cover wrapper, using poked holes as a guide for placement.

Fold over corners at a 45° angle and glue in place. **Fold over** edges and glue down, making stiff blue cover, as shown below. Cut out oval windows in front cover of passport.

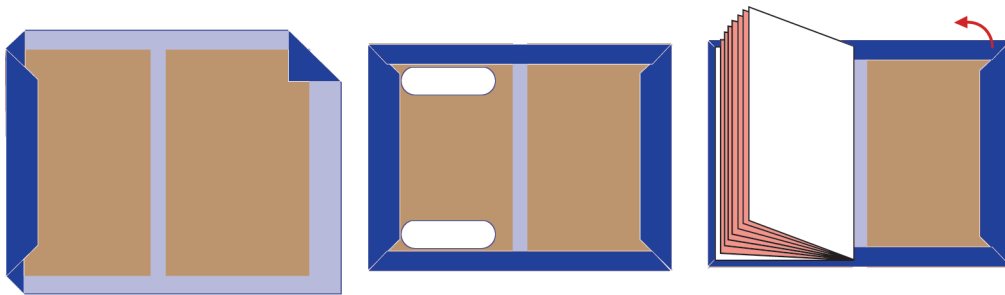

To Assemble Pages:

Print passport pages on ordinary white paper. The pages are meant to be printed on both sides of the paper. Print pages 2-11 odd pages only; then reinsert paper into printer and print even pages only (so page 2 is on the back of page 3, page 6 is on the back of page 7, etc.).

Score at dashed lines, and **trim** at crop marks.

Starting with the inside cover page (L 095297), put pages in correct order.

Sew, if possible, or staple the pages together at the spine. **Fold pages** to form booklet insert.

Glue first page of booklet to inside front cover, leaving approximately 1/8 inches along the top, bottom, and left sides, as shown above. The passport number should be visible through the top oval window. **Fold cover closed** around booklet to determine proper placement. When placement is right, **glue** back of last page of booklet to inside back cover. Do not put glue directly on the spine: there should be some free play in the spine of the finished passport booklet.

Glue b/w photo of bearer (and wife, if applicable) to indicated page in passport. Fill in other information by hand. Stamp or glue in appropriate visas. The bearer should write his/her name on the cover of the passport in the bottom oval window.

This HPLHS Prop Document is for entertainment purposes only. Designed and implemented by Andrew Leman. © 2002 by HPLHS. **All rights reserved.** Permission is hereby granted for the user to print copies for his/her personal use in role-playing games. No other permission is granted, and **any commercial or illegal use of this digital file or the prop you can make with it is ENTIRELY PROHIBITED.**

Please do not distribute this document.
It is available from www.cthulhulives.org

Questions? Ask them.
andrew@ahleman.com

L 095297

We, George Nathaniel,
Marquess Curzon of Kedleston,
Earl of Kedleston, Viscount Rothesdale,
Baron Ravensdale, Knight of the Most Noble
Order of the Garter, a member of His Britannic
Majesty's Most Honourable Privy Council, Knight
Grand Commander of the Most Exalted Order of the
Star of India, Knight Grand Commander of the
Most Eminent Order of the Indian Empire, &c., &c., &c.,
His Majesty's Principal Secretary of State for
Foreign Affairs.

Request and require in the Name of His
Majesty all those whom it may concern to allow
the bearer to pass freely without let or hindrance,
and to afford every assistance and protection
of which may stand in need.



Curzon of Kedleston

REGULATIONS.

1. British passports are issued by the competent authorities throughout the British Empire and by British Diplomatic and Consular officers abroad. The charge for a British passport is 7s. 6d. Application should be made in the authorized form obtainable from those authorities.
2. Passports are issued in the United Kingdom at the Passport Office, Westminster, London, S. W. 1, and at the Branch Passport Office, 36, Dale Street, Liverpool. Passports cannot be issued or renewed at the Passport Office for person not at the time being in the United Kingdom.
3. British subjects ordinarily resident in Ireland should make their applications through the Under-Secretary, Passport Department, Dublin Castle. In the British Dominions or Colonies application should be made to the local authorities.
4. British subjects making their homes or staying for more than three months in a foreign country should be registered at the nearest British Consulate.
5. British passports are not valid beyond two years from the date of issue. They may be renewed for four further periods of two years each, after which, or if at any time there be no further space for visas, a fresh passport must be obtained. The fee for each renewal is 2s.
6. The passport is only available for travel to the countries named on page 4, but may be endorsed for additional countries. The possession of a passport so endorsed does not, however, exempt the holder from compliance with any immigration regulations in force in British or foreign countries or from the necessity of obtaining a visa where required.
7. Passports endorsed as valid for the British Empire are also available for travelling to territory under British protection or mandate, not, however, including Palestine, Mesopotamia or Egypt, for which countries the passport must be specially endorsed.

CAUTION.

This passport is a valuable document, and should not be allowed to pass into the possession of any unauthorized person. If lost or destroyed, the fact should be immediately reported to the Passport Office, London, or to the nearest British authority, and to the local police authorities. New passports can only be issued in such cases after exhaustive enquiries.

H.P.L.H.S., London. Wt. 7300. D5. 8-7-21

[7136]

This HPLHS Prop Document is for entertainment purposes only. Designed and implemented by Andrew Leman.
© 2002 by HPLHS. **All rights reserved.** Permission is hereby granted for the user to print copies for his/her personal use in role-playing games. No other permission is granted, and **any commercial or illegal use of this digital file or the prop you can make with it is ENTIRELY PROHIBITED.**

Please do not distribute this document.
It is available from www.cthulhulives.org

Questions? Ask them.
andrew@ahleman.com

16
VISAS

1
This Passport contains
16 pages.

Ce passeport contient
16 pages.

UNITED KINGDOM OF GREAT BRITAIN AND IRELAND

UNITED KINGDOM OF GREAT BRITAIN AND IRELAND
ROYAUME UNI DE GRANDE BRETAGNE ET DE L'IRLANDE.

No. of PASSPORT

No. du PASSEPORT

L 095297

NAME OF BEARER

NOM DU TITULAIRE

ACCOMPANIED BY HIS WIFE
(Maiden name)

ACCOMPAGNÉ DE SA FEMME
(Née)

and by
et de

children
enfants

NATIONAL STATUS

NATIONALITÉ

This HPLHS Prop Document is for entertainment purposes only. Designed and implemented by Andrew Leman. © 2002 by HPLHS. **All rights reserved.** Permission is hereby granted for the user to print copies for his/her personal use in role-playing games. No other permission is granted, and **any commercial or illegal use of this digital file or the prop you can make with it is ENTIRELY PROHIBITED.**

Please do not distribute this document.
It is available from www.cthulhulives.org

Questions? Ask them.
andrew@ahleman.com

DESCRIPTION
SIGNALEMENT

Wife - Femme

Profession }
 Profession }
 Place and date of birth }
 Lieu et date de naissance }
 Domicile }
 Domicile }
 Height } ft. in. } ft. in. }
 Taille }
 Colour of eyes }
 Couleur des yeux }
 Colour of hair }
 Couleur de cheveux }
 Special peculiarities }
 Signes particuliers }

CHILDREN - ENFANTS

Name	Age	Sex
Nom	Age	Sexe

.....

This HPLHS Prop Document is for entertainment purposes only. Designed and implemented by Andrew Leman. © 2002 by HPLHS. **All rights reserved.** Permission is hereby granted for the user to print copies for his/her personal use in role-playing games. No other permission is granted, and **any commercial or illegal use of this digital file or the prop you can make with it is ENTIRELY PROHIBITED.**

Please do not distribute this document.
 It is available from www.cthulhulives.org

Questions? Ask them.
andrew@ahleman.com

14
VISAS

3

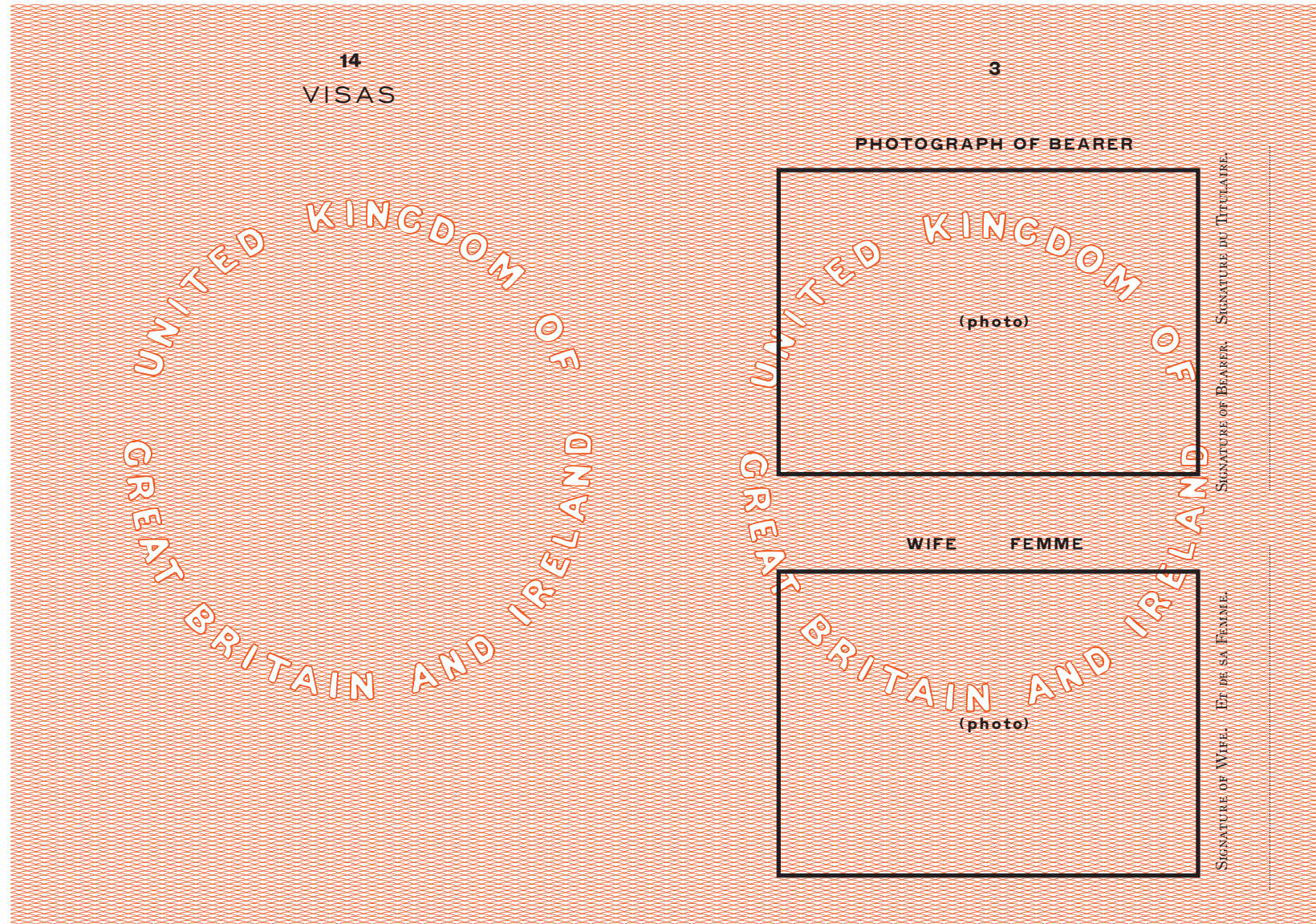

This HPLHS Prop Document is for entertainment purposes only. Designed and implemented by Andrew Leman. © 2002 by HPLHS. **All rights reserved.** Permission is hereby granted for the user to print copies for his/her personal use in role-playing games. No other permission is granted, and **any commercial or illegal use of this digital file or the prop you can make with it is ENTIRELY PROHIBITED.**

Please do not distribute this document.
It is available from www.cthulhulives.org

Questions? Ask them.
andrew@ahleman.com

COUNTRIES FOR WHICH THIS PASSPORT IS VALID.
PAYS POUR LESQUELS CE PASSEPORT EST VALABLE.



The validity of this passport expires :
Ce passeport expire le :

unless renewed.
à moins de renouvellement.

Issued at /
délivré }
date }
date }



VISAS



This HPLHS Prop Document is for entertainment purposes only. Designed and implemented by Andrew Leman. © 2002 by HPLHS. **All rights reserved.** Permission is hereby granted for the user to print copies for his/her personal use in role-playing games. No other permission is granted, and **any commercial or illegal use of this digital file or the prop you can make with it is ENTIRELY PROHIBITED.**

Please do not distribute this document.
It is available from www.cthulhulives.org

Questions? Ask them.
andrew@ahleman.com

12
VISAS

UNITED KINGDOM OF
GREAT BRITAIN AND IRELAND

5
RENEWALS
RENOUVELLEMENTS

1
2
3
4
UNITED KINGDOM OF
GREAT BRITAIN AND IRELAND

OBSERVATIONS.

This Passport is not valid for the United States of America unless vise by a United States Consul before leaving the United Kingdom.

This HPLHS Prop Document is for entertainment purposes only. Designed and implemented by Andrew Leman. © 2002 by HPLHS. **All rights reserved.** Permission is hereby granted for the user to print copies for his/her personal use in role-playing games. No other permission is granted, and **any commercial or illegal use of this digital file or the prop you can make with it is ENTIRELY PROHIBITED.**

Please do not distribute this document.
It is available from www.cthulhulives.org

Questions? Ask them.
andrew@ahleman.com

6
VISAS

UNITED KINGDOM
OF GREAT
BRITAIN AND IRELAND

11
VISAS

UNITED KINGDOM
OF GREAT
BRITAIN AND IRELAND

This HPLHS Prop Document is for entertainment purposes only. Designed and implemented by Andrew Leman.
© 2002 by HPLHS. **All rights reserved.** Permission is hereby granted for the user to print copies for his/her personal use in role-playing games. No other permission is granted, and **any commercial or illegal use of this digital file or the prop you can make with it is ENTIRELY PROHIBITED.**

Please do not distribute this document.
It is available from www.cthulhulives.org

Questions? Ask them.
andrew@ahleman.com

10
VISAS

7
VISAS

UNITED KINGDOM OF
GREAT BRITAIN AND IRELAND

UNITED KINGDOM OF
GREAT BRITAIN AND IRELAND

This HPLHS Prop Document is for entertainment purposes only. Designed and implemented by Andrew Leman. © 2002 by HPLHS. **All rights reserved.** Permission is hereby granted for the user to print copies for his/her personal use in role-playing games. No other permission is granted, and **any commercial or illegal use of this digital file or the prop you can make with it is ENTIRELY PROHIBITED.**

Please do not distribute this document.
It is available from www.cthulhulives.org

Questions? Ask them.
andrew@ahleman.com

8
VISAS

UNITED KINGDOM OF
GREAT BRITAIN AND IRELAND

9
VISAS

UNITED KINGDOM OF
GREAT BRITAIN AND IRELAND

This HPLHS Prop Document is for entertainment purposes only. Designed and implemented by Andrew Leman.
© 2002 by HPLHS. **All rights reserved.** Permission is hereby granted for the user to print copies for his/her personal use in role-playing games. No other permission is granted, and **any commercial or illegal use of this digital file or the prop you can make with it is ENTIRELY PROHIBITED.**

Please do not distribute this document.
It is available from www.cthulhulives.org

Questions? Ask them.
andrew@ahleman.com

BRITISH PASSPORT



UNITED KINGDOM OF
GREAT BRITAIN AND IRELAND

This HPLHS Prop Document is for entertainment purposes only. Designed and implemented by Andrew Leman. ©2002 by HPLHS. All rights reserved. Permission is hereby granted for the user to print copies for his/her personal use in role-playing games. No other permission is granted, and **any commercial or illegal use of this digital file or the prop you can make from it is ENTIRELY PROHIBITED.**

Please do not distribute this file.
It is available at www.cthulhulives.org

Questions? Ask them.
andrew@ahleman.com

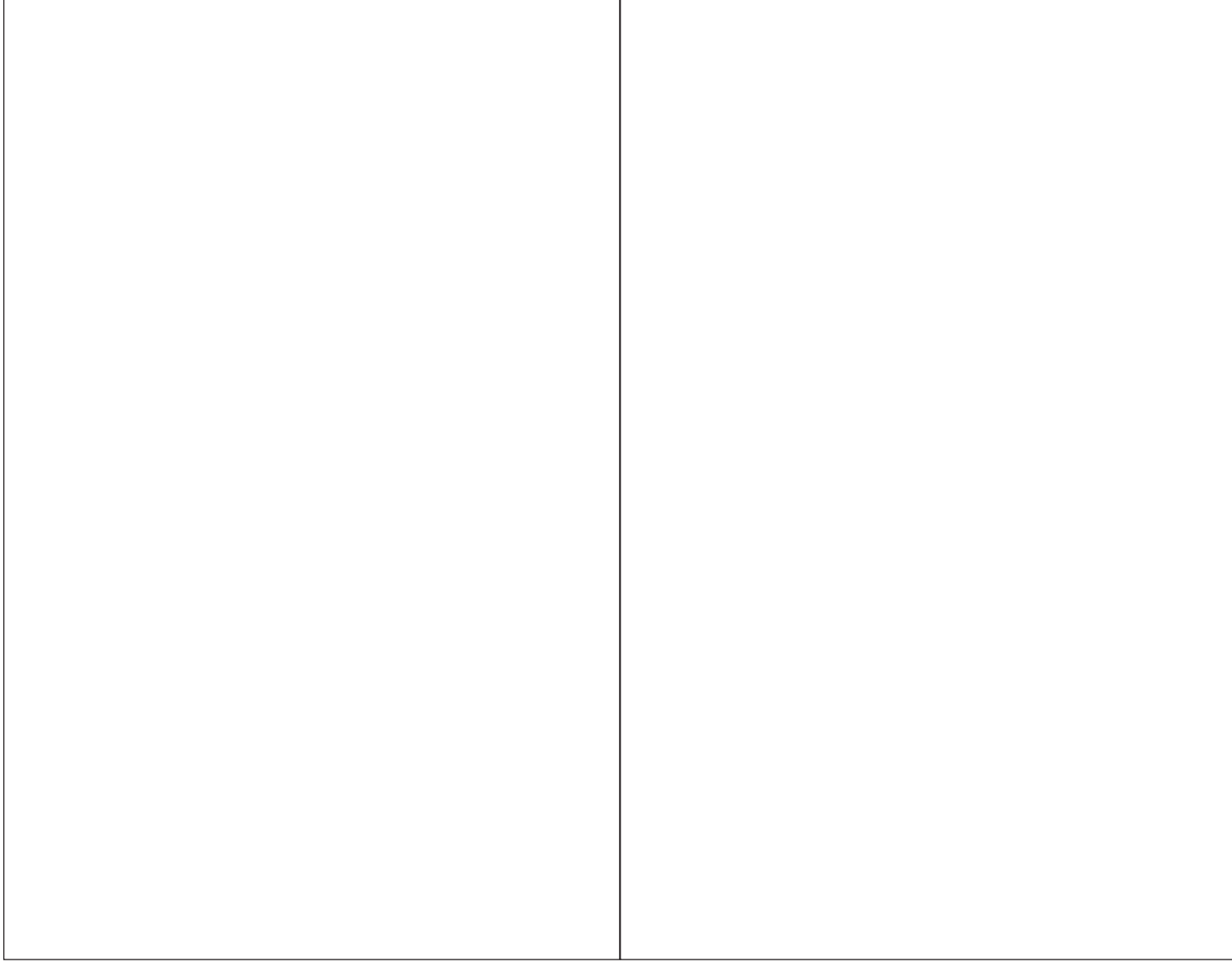

Cover boards. Print on bristol board or cardstock.

This HPLHS Prop Document is for entertainment purposes only. Designed and implemented by Andrew Leman. ©2002 by HPLHS. All rights reserved. Permission is hereby granted for the user to print copies for his/her personal use in role-playing games. No other permission is granted, and **any commercial or illegal use of this digital file or the prop you can make from it is ENTIRELY PROHIBITED.**

Please do not distribute this file.
It is available at www.cthulhulives.org

Questions? Ask them.
andrew@ahleman.com